





# **Trial Evo MY'12 250/300cc.** **Vehicle completely for road use**



Parts	Assembly procedure
Mirrors	Assemble the mirrors on the handlebar with the proper bands.
Digital speedometer	<p>Fix the speedometer on the handlebar as showed on the photo following the assembly instructions enclosed with it. Put the magneto on the spokes and fix the sensor on the lower part of the fork interposing the rubber thickness between the fork and the sensor. For a correct assembly, the digital speedometer has to be set with a wheel circumference of <b>2110mm</b>.</p> <div style="display: flex; justify-content: space-around;">   </div>

## OUTLINE TO DRILL THE FENDER

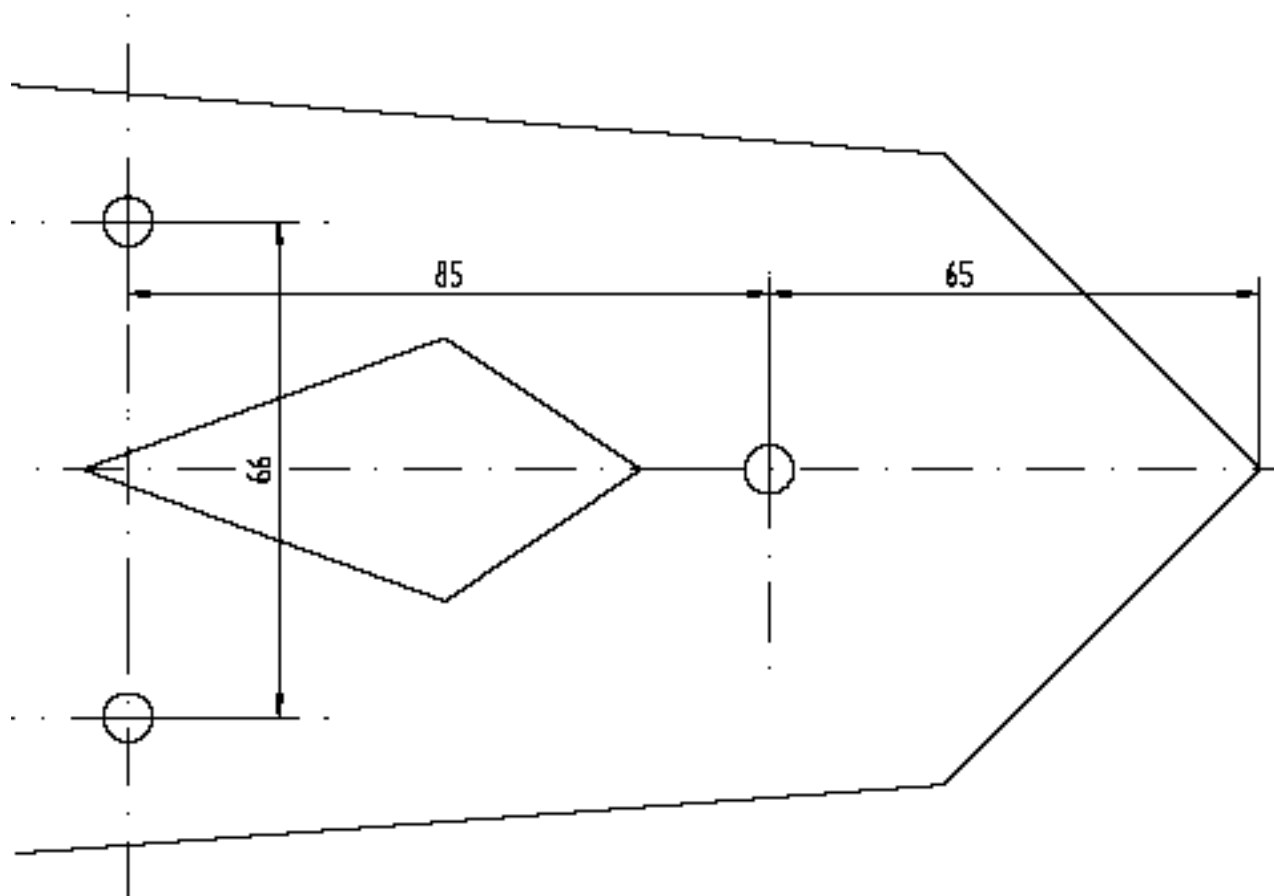

## Number plate:

1. Insert from the inside the lights wires and the rubber on the big hole of the number plate and put the light-box on the proper tongues.
2. Fix the plastic of the rear light with the proper gasket.
3. Make a hole in the lateral side of the number plate in the present references. Assemble the indicators fixing them



# Trial Evo MY'12 250/300cc. Vehicle completely for road use



- with M6x20 screws and flanged nut. Attention!! The indicator glasses must have the water drain at the bottom.
- After disassembling of the rear fender pass the electric system through the hole on the fender and connect it respecting the colours of indicators' wires.
  - Make 3 holes  $\varnothing 6,5$  on the fender to fix the number plate (use the proper outline), put it and make a hole  $\varnothing 6,5$ .
  - Fix the number plate with 2 units M6x16 screws and the M6x35 one, washers and self-locking nuts inserting the 2 proper spacers between the fender and the number plate (all of them in the rear fixing).
  - Fix the wires of the electric system in the proper hooks under the fender.

## Headlight holder with indicators

Assemble the front light and the pilots on the headlight holder (see following drawing) fixing them from the inside with the proper elastic rings.

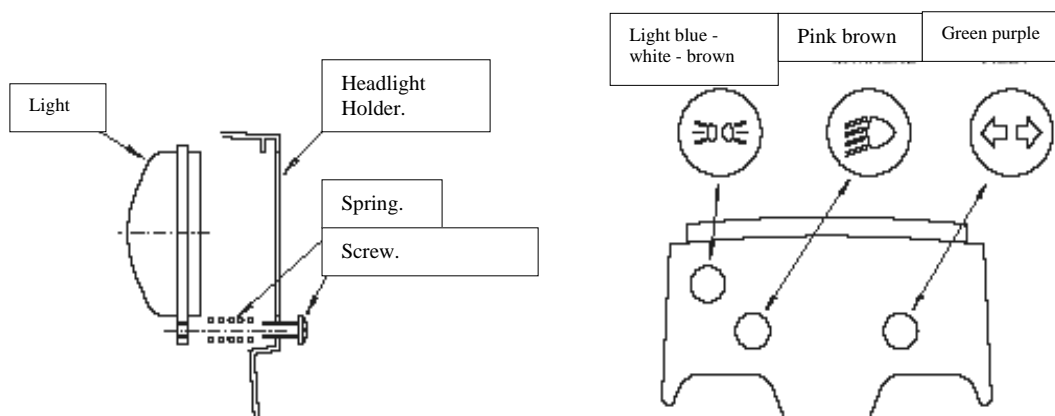

## Indicators

Fix the rh indicator with M6x20 screw and put in the headlight holder the rectifier-intermittence (see drawing n.1). connect the pilots system and the light respecting the wires' colours. Fix the headlight holder as showed in the drawing n. 2. Tilt the horn on the left side. Attention! On the indicators is necessary to remove the position hook.

Drawing n. 1

Drawing n. 2

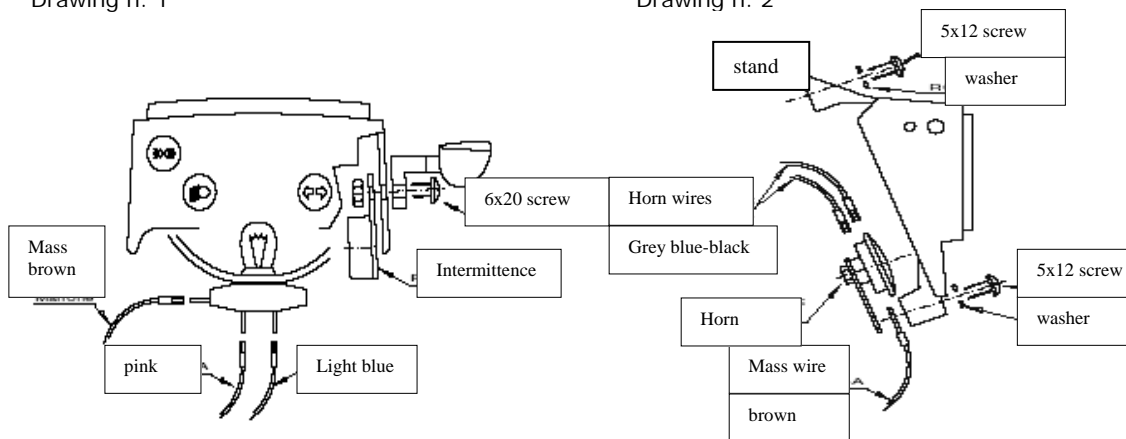

## Stop switches

Assemble the stop switch on the front brake lever replacing it at the registered lever screw, then connect it to the electric system. Assemble the other switch on the brake pedal using the proper plate (to fix in the place of brake pedal standstill) and the special supplied nut (see the following fender photo) and connect the switch to the system placing it as showed on the same photo.



# **Trial Evo MY'12 250/300cc.** **Vehicle completely for road use**



## **Electric equipment**

The bike is supplied with 2 assembled electric equipments: the central and the homologation ones. To obtain a bike in homologation version it is sufficient to disconnect the connector to the electric petcock and the white connector between the central electric equipment and the off-road engine stop lights switch. The proper homologation electric equipment connector has to be connected to the electric petcock feed one (trough this connector is fed the homologation electric equipment). The central electric equipment's white connector has to be connected with its opposing part on the homologation electric equipment (in this way the engine stop is connected). Attention!! The electric switch works only manually turning the proper knob.

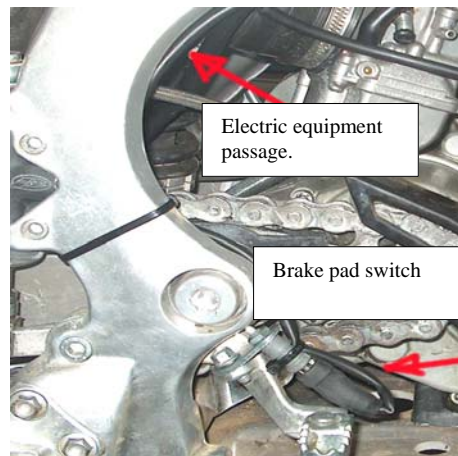
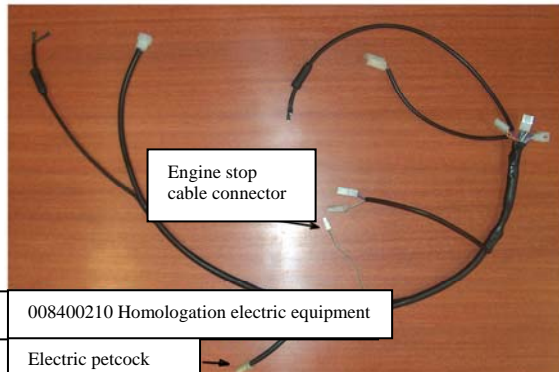

## **Stand**

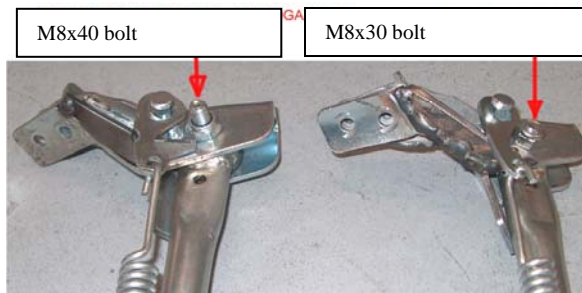

Attention!! To repair the automatic return of the stand it is sufficient to replace the M8x30 bolt with the M8x40 one supplied with the kit.

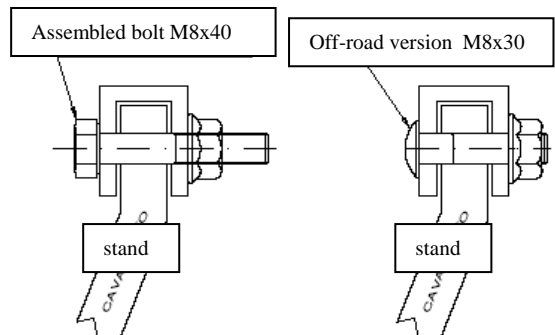



# **Trial Evo MY'12 250/300cc.** **Vehicle completely for road use**



## **Carburettor**

Replace the assembled jets (race setting) with the indicated ones in the following schedule in the "ROAD USE KIT" column. To complete the kit assemble the supplied valve plate.

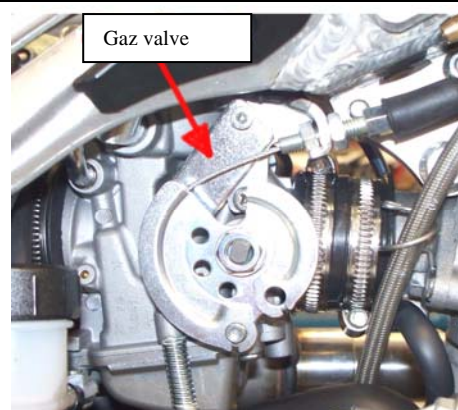

Item	250		300	
	Racing	Road use kit	Racing	Road use kit
Pilote jet	27,5	17,5	27,5	17,5
Needle	5D132 3°	5D132 2°	5D132 3°	5D132 2°
Main jet	127,5	120	120	120
Kick	No	Yes – See photo	No	Yes – See photo
Screw	Open 2,5 turns	Open 3,5 turns	Open 2 turns	Open 3,5 Turns

**Note: The needle's position is always indicated starting from the top.**

## **Info**

**Attention! Those instructions are related to the bike as supplied to the dealer, if will be made other modifications, in addition to the ones above mentioned, those have to be completely removed.**